

Steps:

1. Sketch Closet Walls as Top View
2. Record Accurate Measurements
3. Note Obstacles & Door Swings
4. Plan Your Design (FiveStarMoulding.ca Resources)

Description:

Customer Name: _____

Closet Name: _____

Closet Location: _____

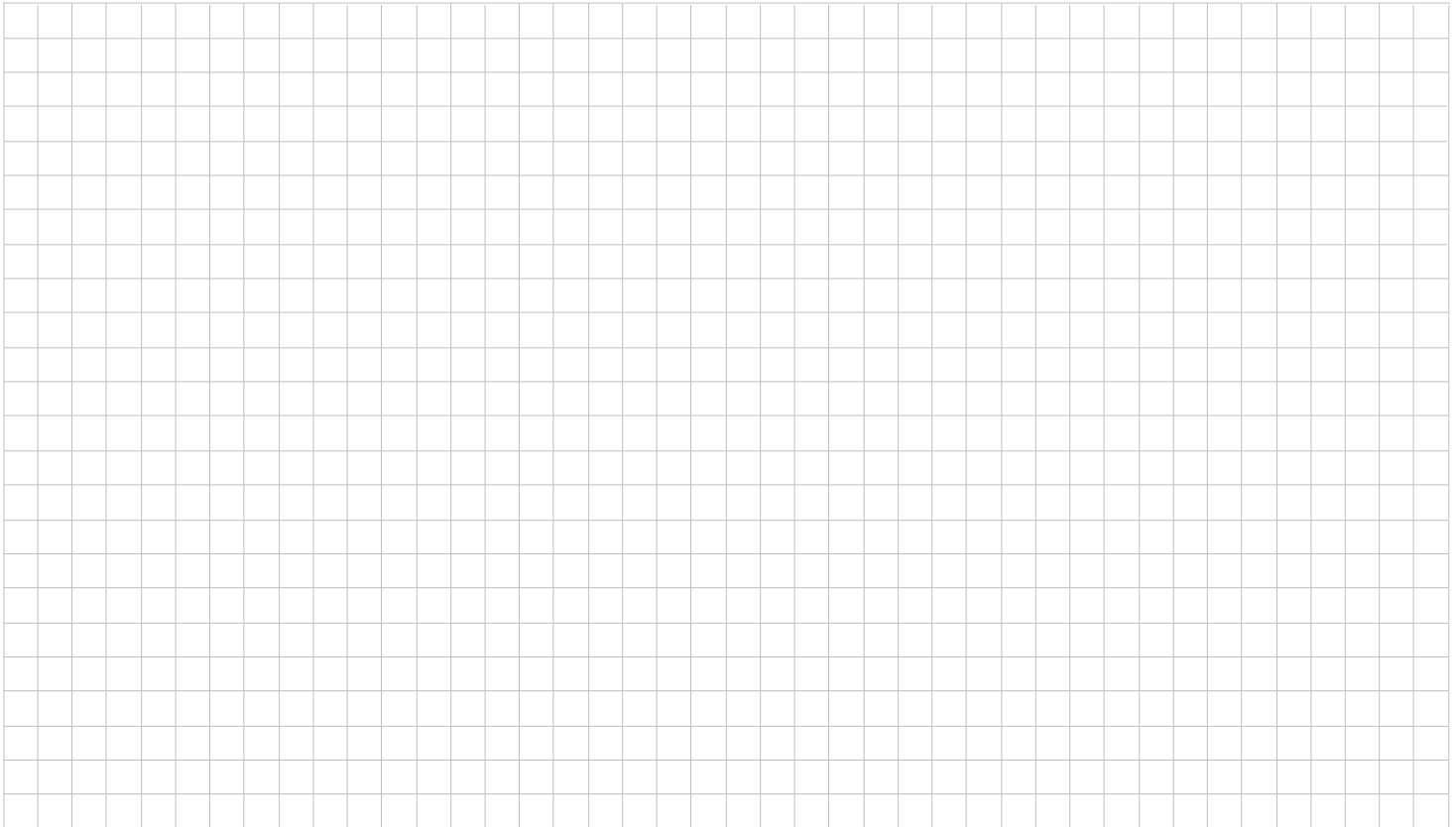

Identify obstacle locations by using vertical and horizontal position references.

Additional Measurements:

Ceiling Height: _____
 Baseboard Height: _____
 Door Opening w/Trim: _____
 Existing Safe: _____
 Other: _____

Obstacle Position References:

Obstacle 1. Electrical Outlets Obstacle 6. Exposed Wiring
 Obstacle 2. Light Switch Obstacle 7. Plumbing Controls
 Obstacle 3. Network Panel Obstacle 8. Attic Overhead Door
 Obstacle 4. Electrical Panel Obstacle 9. _____
 Obstacle 5. Door Swing Obstacle 10. _____

Other:

Wall Material: Drywall Concrete Brick Wood Floor Material: Tile Carpet Wood

Steps:

1. Sketch Closet Walls as Top View
2. Record Accurate Measurements
3. Note Obstacles & Door Swings
4. Plan Your Design (FiveStarMoulding.ca Resources)

Description:

Customer Name: Eric Peterson
 Closet Name: Eric's walk-in closet
 Closet Location: Bedroom master closet

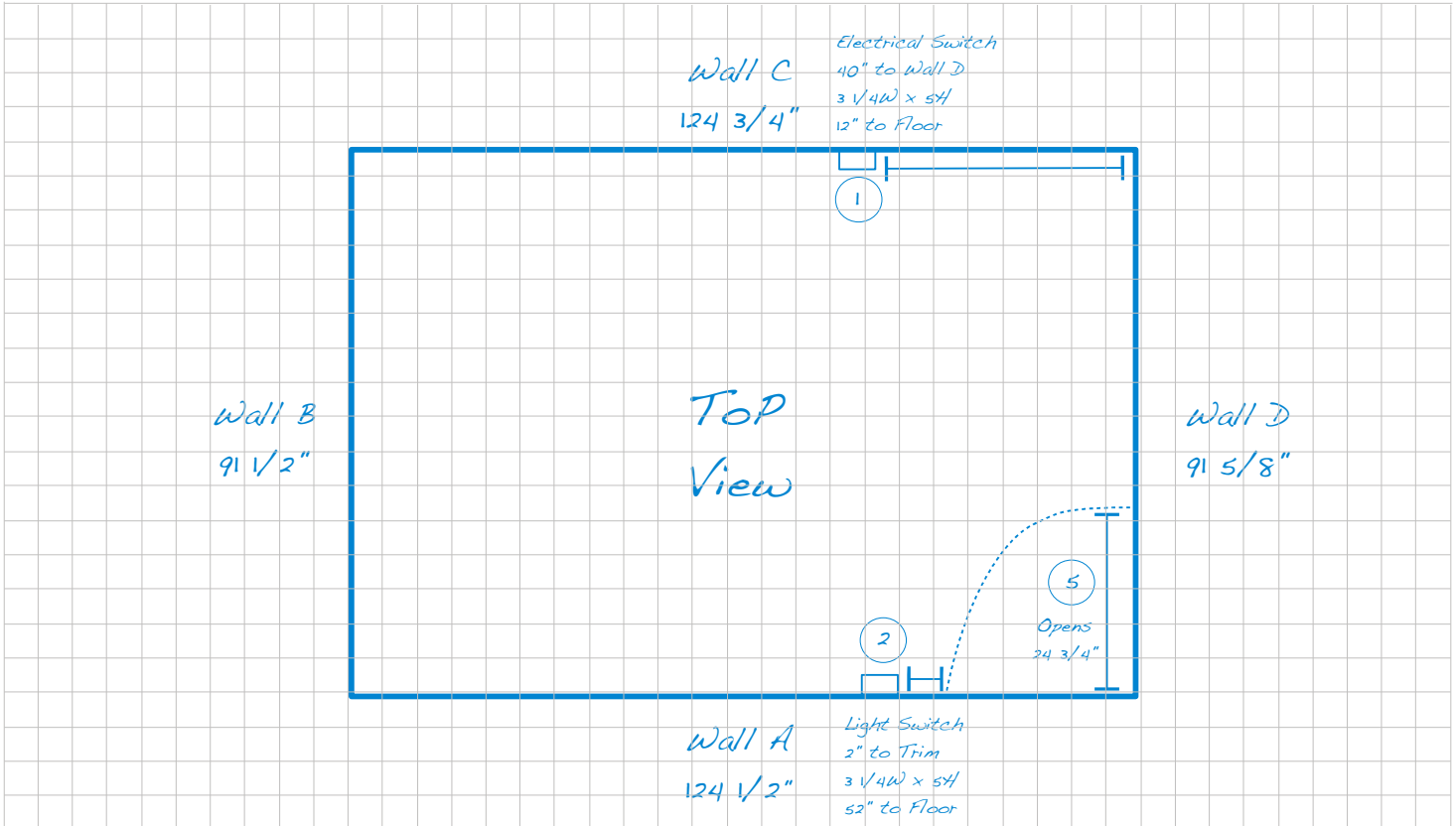

Identify obstacle locations by using vertical and horizontal position references.

Additional Measurements:

Ceiling Height: 120"
 Baseboard Height: 5 1/4"
 Door Opening w/Trim: 32 1/2" W x 100" H
 Existing Safe: _____
 Other: _____

Obstacle Position References:

- | | |
|--------------------------------|---------------------------------|
| Obstacle 1. Electrical Outlets | Obstacle 6. Exposed Wiring |
| Obstacle 2. Light Switch | Obstacle 7. Plumbing Controls |
| Obstacle 3. Network Panel | Obstacle 8. Attic Overhead Door |
| Obstacle 4. Electrical Panel | Obstacle 9. _____ |
| Obstacle 5. Door Swing | Obstacle 10. _____ |

Other:

Wall Material: Drywall Concrete Brick Wood Floor Material: Tile Carpet Wood